



Bermondsey Project

Client
Southwark GP Nominee 1 Ltd. and
Southwark GP Nominee 2 Ltd.



**Kohn Pedersen Fox Associates
(International) PA**
Architects and Planning Consultants
7a Langley Street, London WC2H 9JA
T: +44 (0) 20 3119 5300
<http://www.kpf.com>

Structural Engineer
WSP - Tel: 207 337 1700

MEP Engineer
Hilson Moran - Tel: 207 940 8888

Landscape Consultant (Strategy)
Arup - Tel: 207 636 1531

Landscape Consultant (Design)
Andy Sturgeon. Tel: 127 367 2575

Structural Engineer (Building F)
AKT II - Tel: 207 250 7777

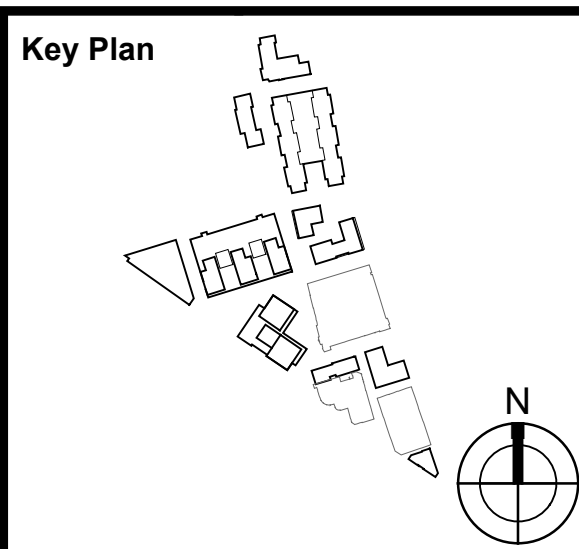

Notes

- OUTLINE COMPONENT

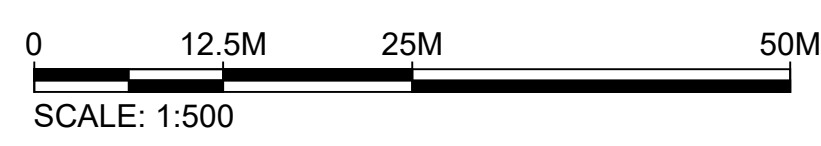

A	AMENDED PROPOSALS	16.09.19

Proj. No.	Project
2607	Bermondsey Project

Scale 1:500 @ A0

Drawing Title and No.
PROPOSED SITE BASEMENT PLAN
PROPOSED

Drawing Ref. 2607-KPF-MPLN-B1-DR-PLN-
A-0099

© 2007 MCGRAW HILL, A DIVISION OF THE MCGRAW HILL COMPANIES, INC. ALL RIGHTS RESERVED.